

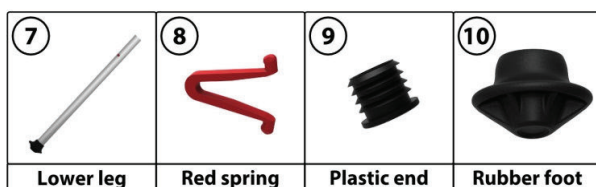

Walkstool®

Comfort models



Walkstool®

Basic models

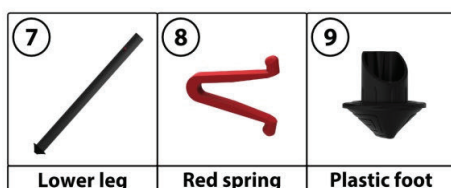



Things to be aware of when replacing the center piece (metal part):

- The center piece is being turned 180 degrees in the plastic joints to lock.
- This means that at least two of the plastic joints need to be removed from Walkstool to be able to remove the center piece and attach a new one.

We advise you to do the following when replacing the center piece on Walkstool:

- Remove the lower legs completely from Walkstool (when in locked position, push the red spring and pull out the lower legs).
- Remove two plastic joints from the upper legs without damaging the aluminum tubes.
- Remove the center piece and the two plastic joints from the plastic joint that is still attached to Walkstool.
- Attach the new center piece with two new plastic joints – and after that to the third plastic joint on Walkstool (remember that all plastic joints need to be locked to the center piece by turning 180 degrees).
- Use a rubber hammer to attach the two plastic joints on the upper legs. On every stroke, pay extra attention that the plastic joint is in a straight position when attaching it to the upper leg.
- Insert each lower leg into the upper legs by pushing both sides of the red plastic spring.

Best regards,
Scandinavian Touch AB



These are our guidelines for replacing the plastic stud that is used to fix the seat on Walkstool.

- If the plastic stud is detached (loose) but otherwise in good condition, it might be sufficient to reattach the plastic stud to the plastic cup by using a rubber/plastic hammer. If the plastic stud was damaged, replace it with a new one. After attaching the stud to the seat/plastic cup, verify that everything has been attached properly by firmly pulling the seat near the corner. If the plastic stud detaches when doing this check, it indicates that the plastic cup has been damaged and needs to be replaced.
- Detaching the plastic cup will require some force. Be careful not to damage the aluminum tube during this process.
- Use a plastic/rubber hammer when attaching the plastic cup to the upper leg. On every stroke, pay extra attention that the plastic cup is in a straight position when attaching it to the upper leg.
- After the plastic cup is replaced you should be able to easily reattach the seat with a new plastic stud (using a rubber/plastic hammer). Verify that the plastic stud and seat is properly fixed by pulling the seat near the corner.

Best regards,
Scandinavian Touch AB



Instructions for replacing the red spring

1. To make it easier removing the old red spring, we advise you to cut off its two "heads" on both sides. This can be done using a wire cutter as seen on the picture.



2. Removing the red spring from the tube is best done using a medium/small screw driver. Push it towards the tube hole and fiddle until you can remove it completely.

Insertion of red spring:

3. Make sure you insert the red spring into the tube in the correct direction.



4. Push it towards the spring hole with a screw driver, but be careful not to push it too far.



5. Use a screw driver to carefully move the red spring into position and make it snap out thru the spring holes on both sides.



Instructions for attaching a new rubber foot

1. Remove the old rubber foot if it is still attached.

2. The lower leg should have a plastic end attached. If not, attach a plastic end to the lower leg by using a hammer. The plastic end will protect the rubber foot from being damaged by the aluminum tube.

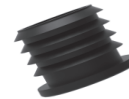

3. Attach the rubber foot to the lower leg. Use a hammer for the last centimeter, as it is important that the rubber foot is fully attached to the lower leg.



Instructions for replacing the seat

1. To remove the old seat, all three plastic studs need to be removed from the plastic cups. This can be done by using a knife and a hammer, as seen on the picture. Quite a lot of force is needed.



2. A small piece of the plastic stud will remain in the plastic cup. Remove this on all three plastic cups by using a hammer and a screw driver or center punch.



3. When attaching the new seat, use a rubber hammer to attach the plastic studs to the plastic cups. Verify that the plastic stud and seat is properly fixed by pulling the seat near each corner.